

UNIVERSAL VOLTAGE TIMING MODULE



12 – 240VDC 24 – 240VAC
ONE AMPERE LOAD RATING ENCAPSULATED

Series U601 - ON DELAY

FULLY SOLID STATE CMOS DIGITAL CIRCUITRY

- Life Expectancy –unlimited
- Environment Protected
- Tamper Proof
- No False Operate
- Small Size – 2"x 2" x 53/64"
- Lightweight – approximately 2.5 oz.
- Rugged

A solid state switch turns the load ON at the end of a timed period and it remains in this condition until power is removed. Power must be applied continuously during the timing period and for as long as the load is to be energized. Removal or interruption of power at any time will cause the timer to reset. The next cycle can then be initiated by application of power.

Control the timing of valves, SFHP motors, lamps, relays, magnetic line starters, and actuators rated less than 1 ampere (10 amps inrush). CMOS digital circuitry, with solid state output switching. P/C boards and internal components are encapsulated in a flame retardant molded housing, fitted with quick connect wiring terminals. Available in all standard voltages and frequencies. Fixed or adjustable timing from .1 seconds to 24 hours.

TIMING DIAGRAM

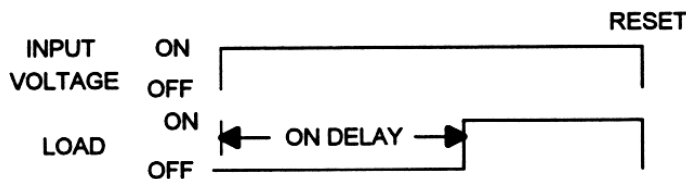

SPECIFICATIONS

1. Repeat Accuracy: $\pm 0.1\%$ or 16 ms. Whichever is greater
2. Combined Effect of Temperature and Voltage upon Repeat Accuracy: $\pm 1\%$
3. Reset Time: 16 ms.
4. Operating Voltage: 12 – 240 V
5. Load Current: Steady State – 40 ma. Min., 1 Ampere Max.
6. Voltage Drop: 1.5V Typical at 1 Ampere
7. Leakage Current: 5 ma.
8. Dielectric Strength: 1500 VRMS
9. Insulation Resistance: 100 Megohms Min.
10. Input Transient Protected
11. Temperature Ambients: Operating -40°C to +70°C ; Storage -55°C to +70°C
12. Humidity-Operating: 95% Relative
13. Linearity(Option A or D) : $\pm 5\%$ Minimum from 10% to 90% of range
14. Timing Tolerance: $\pm 9\%$ + Tolerance of Rt Std., $\pm 5\%$ Special (Fixed)
15. DC Polarity Insensitive

HOW TO ORDER U601 – (T) (P)

SERIES	(T) = TIME RANGE	(P) = OPTIONS
U601	P = 0.1 - 5 SEC.	O - CUSTOMER SUPPLIES OWN POTENTIOMETER OR RESISTOR A - POTENTIOMETER SUPPLIED AS LOOSE PART *B - EXTERNALLY INSTALLED RESISTOR *C - FACTORY FIXED INTERNAL D - TRIMMER POTENTIOMETER INSTALLED ON TERMINALS R - INTERNAL POTENTIOMETER WITH THRU SHAFT S - INTERNAL POTENTIOMETER WITH SCREWDRIVER SLOT
	1 = 0.1 - 10 SEC.	
	L = 0.2 - 20 SEC.	
	J = 0.3 - 30 SEC.	
	M = 0.6 - 60 SEC.	
	2 = 1 - 100 SEC.	
	K = 1.2 - 120 SEC.	
	F = 2 - 180 SEC.	
	E = 3 - 300 SEC.	
	3 = 10 - 1000 SEC.	
	4 = 0.1 - 10 MIN.	
	G = 0.3 - 30 MIN.	
	H = 0.6 - 60 MIN.	
	5 = 1 - 100 MIN.	
	V = 3 - 300 MIN.	
6 = 10 - 1000 MIN.		
D = 1 - 24 HRS.		

** For Fixed Time Specify The Value In Seconds, Minutes, Or Hours*

MADE IN USA

EXAMPLE P/N: U601-2R This is a UNIVERSAL ON DELAY 1A Rated Solid State Timer with an adjustable 1-100 second DELAY. The input is any voltage between 12 – 240VDC or 24-240VAC. The timing adjustment potentiometer is internal with through shaft.

AMERICAN CONTROL PRODUCTS
 A DIV. OF PRECISION TIMER CO., INC.
 47 WESTBROOK INDUSTRIAL PARK ROAD
 WESTBROOK, CT. 06498

PHONE: (860)399-6253
 EMAIL: info@precisiontimer.com

FAX: (860)399-5619
 Web Site: precisiontimer.com

TECHNICAL BULLETIN

SOLID STATE TIMING MODULE

PAGE 1
 OF 2

DATE
 6-4-01

U601

REV
 B

CALIBRATION RESISTANCE VS TIME



ACCESSORIES – AVAILABLE FROM STOCK

ORDER P/N: **PM – 1M 1 MEGOHM ± 20%**
PM – 100K 100 KOHM ± 20%

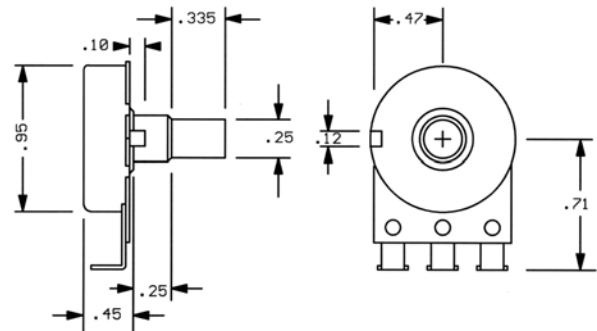

TYPICAL WIRING

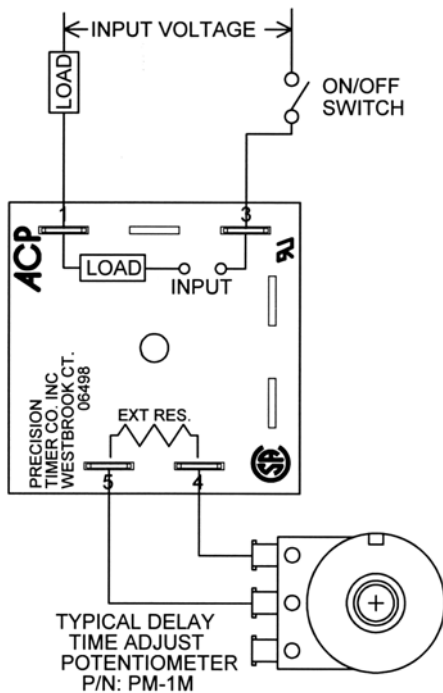

OUTLINE DRAWING

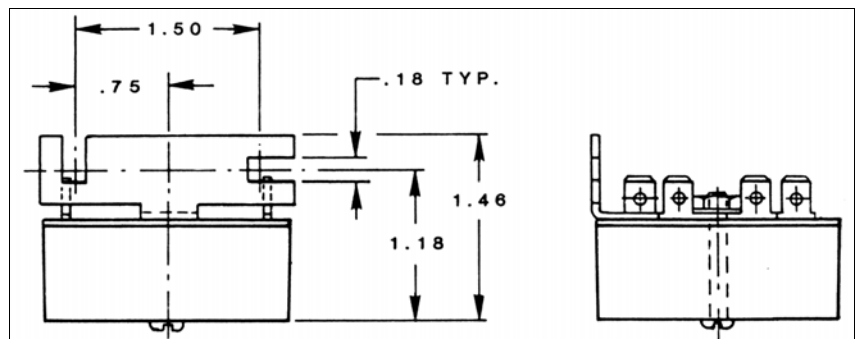
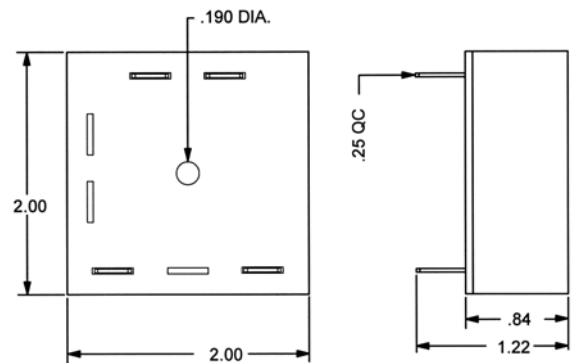

Order bracket mount model as: **U601BM – (T) (P)**

MADE IN USA

AMERICAN CONTROL PRODUCTS

A DIV. OF PRECISION TIMER CO., INC.
 47 WESTBROOK INDUSTRIAL PARK ROAD
 WESTBROOK, CT. 06498

PHONE: (860)399-6253
 EMAIL: info@precisiontimer.com

FAX: (860)399-5619
 Web Site: precisiontimer.com

TECHNICAL BULLETIN

SOLID STATE TIMING MODULE

PAGE 2
 OF 2

DATE
 6-4-01

U601

REV
 B