



HORSEPOWER RATED

**HIGH CURRENT DUAL OUTPUT TIMING RELAY**  
**ALTERNATE ACTION TIMER** **SOLID STATE**  
**10 AMPERE RATING 1/3 HP**  
**Series 8496B – DUAL OUTPUT MOTOR REVERSING**  
**CMOS DIGITAL CIRCUITRY** **ENCAPSULATED MODULE**

**UL** US  
 E98340  
**SP**  
 LR46938

- Environment Protected
- Tamper Proof
- No False Operate
- Small Size – 2" x 3" x 1.35"
- Lightweight – approximately 2.5 oz.
- Rugged
- Transient Protected to 6000V

Application of input voltage starts timing and turns load 1 ON. This load remains ON for the preset time and then turns OFF for the preset DWELL time. After the DWELL time is complete the load 2 is turned ON. This load remains ON for the preset ON time then turns OFF for the preset DWELL time after which the load 1 turns ON. The ON & OFF times are independently adjustable. The ON/OFF alternating cycle continues until the input voltage is removed. Interruption of input voltage resets the time to T = 0. The unit is available with the OFF time period first, see below. Asymmetrical ON times can be achieved as shown on page 2. Typical applications include **Oxygen Generation, Dryer Drum Reversing, and Alternating Pumps.** Control the timing of high power electric heaters, FHP motors, lamps, transformers and other high current loads rated less than 10 amps Resistive. CMOS digital circuitry is combined with high current output relay contacts. P/C board and internal components are encapsulated in a flame retardant molded housing, fitted with quick connect wiring terminals. Available in all standard voltages and frequencies. Fixed or adjustable timing from .1 seconds to 24 hours.

**TIMING DIAGRAM**

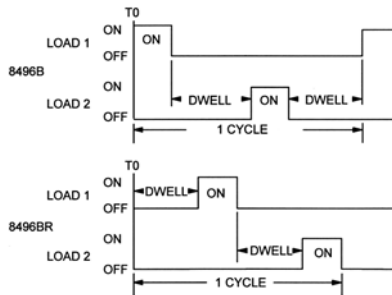

**SPECIFICATIONS**

1. Repeat Accuracy: ± 0.25%
2. Combined Effect of Temperature and Voltage upon Repeat Accuracy: ±2% of Setting
3. Reset Time: 150 ms.
4. Operating Voltage Tolerance: ± 20%
5. Load Current: 10 Amps Resistive at 120/240VAC or 28VDC, 1/3HP @ 120/240VAC
6. Dielectric Strength: 1500 VRMS
7. Insulation Resistance: 100 Megohms Min.
8. Input Transient Protection: 3000V 120V UNITS, 6000V 240V UNITS
9. Temperature Ambients: Operating -40°C to +70°C Storage -55°C to +85°C
10. Humidity-Operating: 95% Relative
11. Linearity (Option A or D): ±5% Minimum from 10% to 90% of range
12. Timing Tolerance: ±9% + Tolerance of Rt Std., ±5% Special (Fixed)

**HOW TO ORDER**

8496B – (T1) (T2) (V) (P1) (P2)  
 8496BR (T1) (T2) (V) (P1) (P2)

SERIES	(T1) = ON TIME RANGE	(T2) = DWELL TIME RANGE	(V) = VOLTAGE	(P1) = ON TIME OPTIONS, (P2) = OFF TIME OPTIONS
8496B ON FIRST	P = 0.1 - 5 SEC.	P = 0.1 - 5 SEC.	1 = 12VDC 2 = 24VDC 3 = 48VDC 4 = 24VAC 5 = 120VAC 6 = 240VAC 7 = 110VDC	O – CUSTOMER SUPPLIES POTENTIOMETER OR RESISTOR A – POTENTIOMETER SUPPLIED AS A LOOSE PART *B – EXTERNALLY INSTALLED RESISTOR *C – FACTORY FIXED INTERNAL D – TRIMMER POTENTIOMETER INSTALLED ON TERMINALS
	1 = 0.1 - 10 SEC.	1 = 0.1 - 10 SEC.		
L = 0.2 - 20 SEC.	L = 0.2 - 20 SEC.			
J = 0.3 - 30 SEC.	J = 0.3 - 30 SEC.			
M = 0.6 - 60 SEC.	M = 0.6 - 60 SEC.			
2 = 1 - 100 SEC.	2 = 1 - 100 SEC.			
K = 1.2 - 120 SEC.	K = 1.2 - 120 SEC.			
8496BR OFF FIRST	F = 2 - 180 SEC.	F = 2 - 180 SEC.	* For Fixed Time Specify The Value In Seconds, Minutes, Or Hours	<b>MADE IN USA</b>
	E = 3 - 300 SEC.	E = 3 - 300 SEC.		
	3 = 10 - 1000 SEC.	3 = 10 - 1000 SEC.		
	4 = 0.1 - 10 MIN.	4 = 0.1 - 10 MIN.		
	G = 0.3 - 30 MIN.	G = 0.3 - 30 MIN.		
	H = 0.6 - 60 MIN.	H = 0.6 - 60 MIN.		
	5 = 1 - 100 MIN.	5 = 1 - 100 MIN.		
	V = 3 - 300 MIN.	V = 3 - 300 MIN.		
	6 = 10 - 1000 MIN.	6 = 10 - 1000 MIN.		
	D = 1 - 24 HRS.	D = 1 - 24 HRS.		

EXAMPLE P/N: 8496B-455CC/5M20M This is a DUAL OUTPUT MOTOR REVERSING 10A Rated Timer with a FACTORY FIXED 5 MINUTE ON TIME and a FACTORY FIXED DWELL TIME OF 20 MINUTES. The INPUT VOLTAGE is 120 VAC.

**AMERICAN CONTROL PRODUCTS**  
 A DIV. OF PRECISION TIMER CO., INC.  
 47 WESTBROOK INDUSTRIAL PARK ROAD  
 WESTBROOK, CT. 06498

PHONE: (860)399-6253  
 EMAIL: info@precisiontimer.com

FAX: (860)399-5619  
 Web Site: precisiontimer.com

**TECHNICAL BULLETIN**

**SOLID STATE TIMING MODULE**

PAGE 1  
 OF 2

DATE  
 6-4-01

**8496B**

REV  
 B

## TYPICAL CALIBRATION RESISTANCE VS TIME

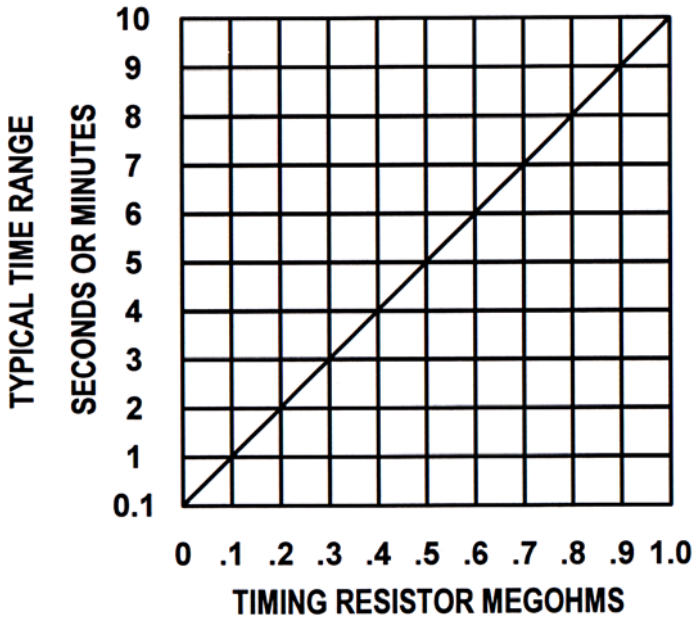

**ACCESSORIES AVAILABLE FROM STOCK**  
**CONTROL POTENTIOMETERS (OPTION A)**  
**ORDER P/N PM-1M 1 MEGOHM ± 20%**

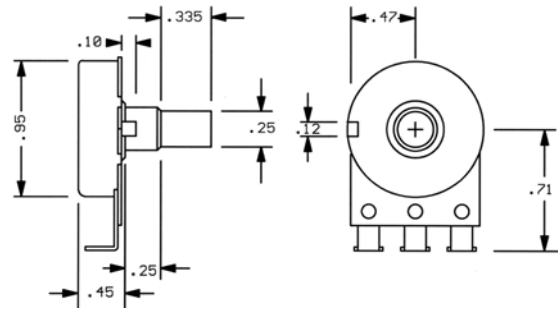

## OUTLINE DRAWING

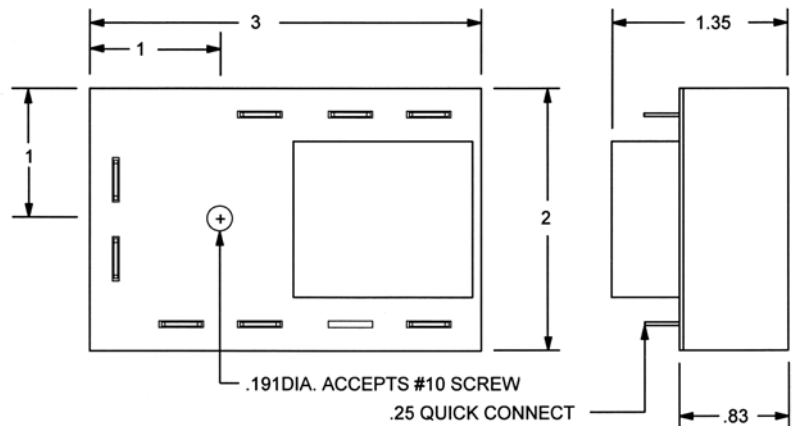

## TYPICAL WIRING

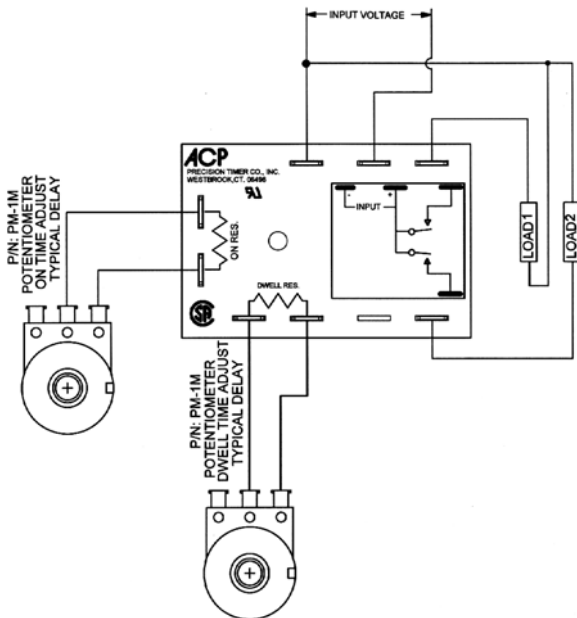

## TYPICAL APPLICATION

TYPICAL WIRING FOR 8496B WITH ASYMMETRICAL ON TIMES

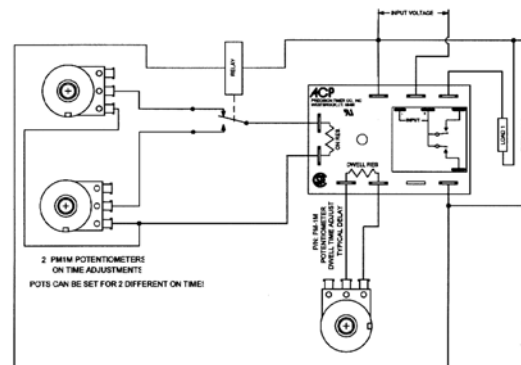

**MADE IN USA**

**AMERICAN CONTROL PRODUCTS**  
 A DIV. OF PRECISION TIMER CO., INC.  
 47 WESTBROOK INDUSTRIAL PARK ROAD  
 WESTBROOK, CT. 06498

PHONE: (860)399-6253  
 E-MAIL: info@precisiontimer.com

FAX: (860)399-5619  
 Web Site: precisiontimer.com

## TECHNICAL BULLETIN

## SOLID STATE TIMING MODULE

PAGE 2  
 OF 2

DATE  
 6-4-01

**8496B**

REV  
 B